

FRONT OF SCHOOL

MONROE HYBRID ENTRY WAY MAP

ENTRY WAY INSTRUCTIONS

- STUDENTS **PICKING UP LUNCH** USE THE MAIN ENTRANCE EVERYDAY
- ENTER AT YOUR DESIGNATED COLOR BASED ON YOUR **FIRST PERIOD OF THE DAY**
- **LATE ARRIVAL** USE THE MAIN ENTRANCE
- STUDENTS USING THE **BIKE CAGE** USE THE YELLOW ENTRANCE

STUDENT DROP OFF PARKING

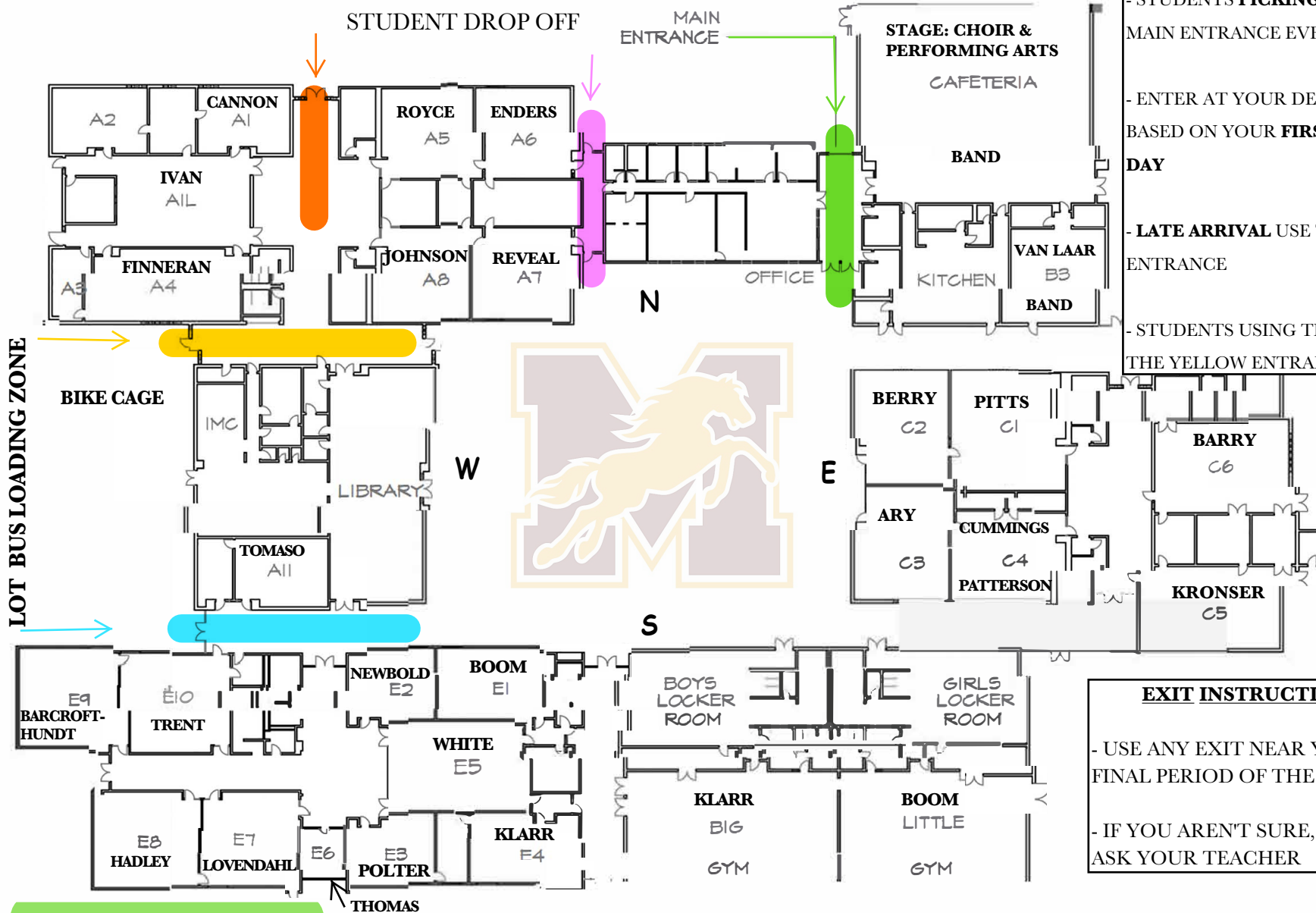

EXIT INSTRUCTIONS

- USE ANY EXIT NEAR YOUR FINAL PERIOD OF THE DAY
- IF YOU AREN'T SURE, PLEASE ASK YOUR TEACHER

GREEN & LUNCH PICK UP & LATE ARRIVAL

- BERRY: C2
- CUMMINGS: C4
- ARY: C3
- KRONSER: C5
- BARRY: C6
- NANSEL/VAN LAAR: B3
- PITTS: C1
- PATTERSON: C4

PINK

- REVEAL: A7
- ENDERS: A6

ORANGE

- ROYCE: A5
- JOHNSON: A8
- IVAN: A1L
- FINNERAN: A4
- CANNON: A1

YELLOW & BIKE CAGE

- POLTER: E3
- NEWBOLD: E2
- KLARR: E4
- BOOM: E1

BLUE

- TRENT: E10
- TOMASO: A11
- HADLEY: E8
- LOVENDAHL: E7
- BARCROFT-HUNDT: E9
- WHITE: E5